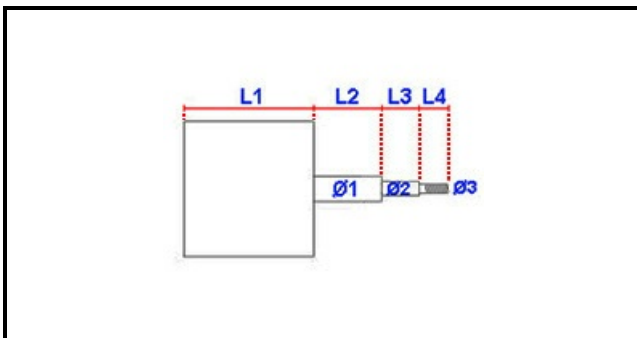

1103907

**FAN MOTOR 0,12KW 230V 50/60Hz**

Date: 27-02-2025

**Technical data**

KILOWATT KW	KW=0,12
MONOPHASE	230V
CAPACITOR	6,3mf

**Manufacturer code**

NIDEC FIR INTERNATIONAL SRL
TECNOEKA SRL
NIDEC FIR INTERNATIONAL SRL
NIDEC FIR INTERNATIONAL SRL