

1103991

# MOTOR K48210 M0211

Date: 26-12-2024



ORIGINAL  
**OSP**  
SPARE PARTS

## Technical data

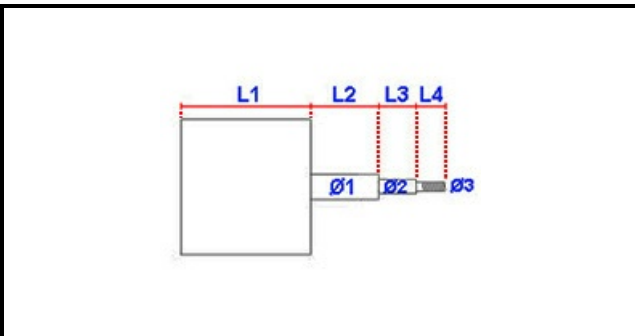

MOTOR LENGHT mm	L1=95mm
SHAFT LENGHT 1 mm	L2=32mm
SHAFT LENGHT 2 mm	L3=24mm
SHAFT DIAMETER mm	Ø1=8mm
KILOWATT KW	KW=0,035
THREADED SHAFT	FILETTATO/THREADED
MONOPHASE	230V
CAPACITOR	6,3 mF
SHAFT DIAMETER 2 mm	Ø3=5mm
SHAFT LENGHT 2 mm	L4=12mm
SHAFT DIAMETER mm	Ø2=6X8mm

## Manufacturer code

GIORIK SPA

GIORIK SPA