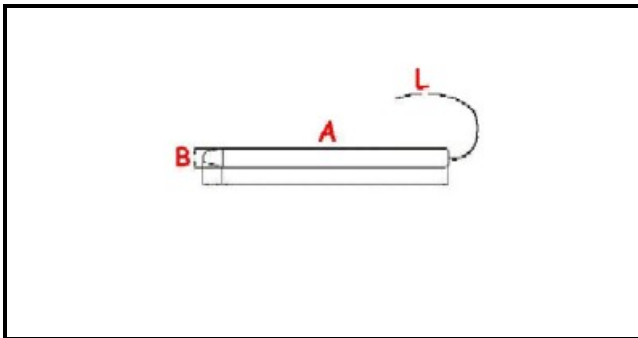

1105030

**BRAISER SWITCH 002109**

Date: 24-11-2024

ORIGINAL  
**OSP**  
SPARE PARTS**Technical data**

MONOPHASE	MONOFASE/MONOPHASE
NUMBER OF POLES	POLI TERMOSTATO/THERMOSTAT POLES=2
NUMBER OF POSITIONS	POLI INTERRUTTORE/SWITCH POLES=4
MAXIMUM TEMPERATURE °	T max=260°
WIRE mm	L=1000mm
PROBE DIAMETER MM	B=4mm
PROBE LENGHT MM	120mm

**Manufacturer code**

ELECTROLUX PROFESSIONAL S.P.A.
E.G.O. ELEKTRO GERATE AG
E.G.O. ELEKTRO GERATE AG