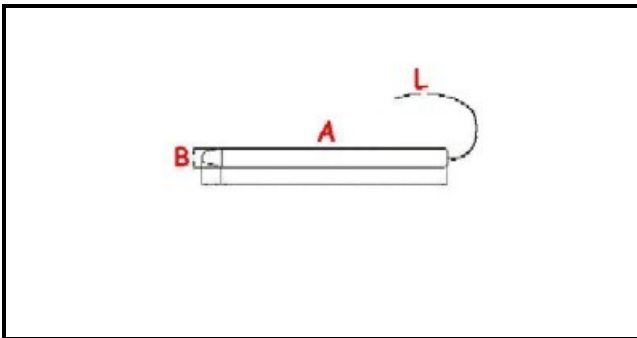

1106009

**BIN THERMOSTAT +1,7°C/+9,5°C SIMAG - SENSOR Ø 10X100mm  
CAPILLARY 1500mm (K55 L1042)**

Date: 22-12-2024

**Technical data**

MONOPHASE	MONOFASE//MONOPHASE
NUMBER OF POLES	POLI/POLES=2
MINIMUM TEMPERATURE °	T min= +1,7°
MAXIMUM TEMPERATURE °	T max= +9,5°
WIRE mm	L=1500mm
PROBE DIAMETER MM	B=10mm
PROBE LENGHT MM	A=100mm

**Manufacturer code**

SCOTSMAN ICE Srl.
MIGEL S.R.L.
CASTEL MAC SRL