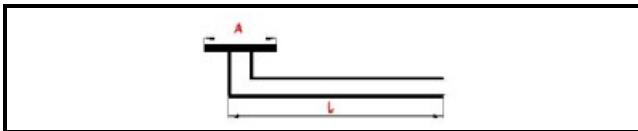

1101373

HEATING ELEMENT 2700/2940W 230/240V

Date: 23-02-2025

ORIGINAL
OSP
SPARE PARTS**Technical data**

DEPTH MM	L=250mm
ELEMENTS	ELEMENTI/ELEMENTS=3
ROUND FLANGE	TONDA/ROUND FLANGE=47mm
DIAMETER mm	A=47mm
KILOWATT KW	KW=2,7
WATT	WATT=2700
THREE PHASE	TRIFASE/THREEPHASE
NUMBER OF POLES	POLI/POLES=6
GASKET	2101032
IMMERSION HEATING ELEMENTS	IMMERSIONE/IMMERSION

Manufacturer code

UNIVERBAR SRL A SOCIO UNICO
DIHR - ALI GROUP SRL A SOCIO UNICO