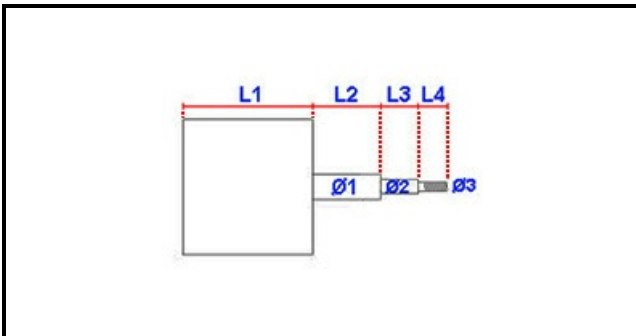

1103548

FAN MOTOR 230V 0,12KW 50HZ

Date: 22-12-2024

**Technical data**

MOTOR LENGHT mm	L1=95mm
SHAFT LENGHT 1 mm	L2=33mm
SHAFT LENGHT 2 mm	L3=23mm
SHAFT DIAMETER mm	Ø1=8mm
KILOWATT KW	KW=0,12
THREADED SHAFT	FILETTATO/THREADED
MONOPHASE	230V
SHAFT DIAMETER 2 mm	Ø3=5mm

Manufacturer code

NIDEC FIR INTERNATIONAL SRL
NIDEC FIR INTERNATIONAL SRL
SMEG SPA