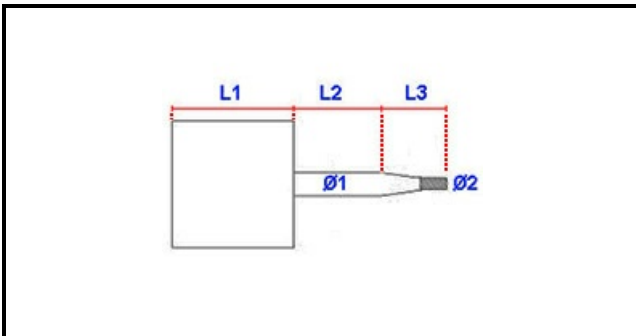

1103850

**MOTOR 0.25HP 230V 50HZ 1400/1700RPM**

Date: 15-11-2024

ORIGINAL  
**OSP**  
SPARE PARTS**Technical data**

KILOWATT KW	KW=0.186
MONOPHASE	230V
FAN	Y=3109147
CAPACITOR	5mf

**Manufacturer code**

LAINOX ALI GROUP SRL A SOCIO UNICO