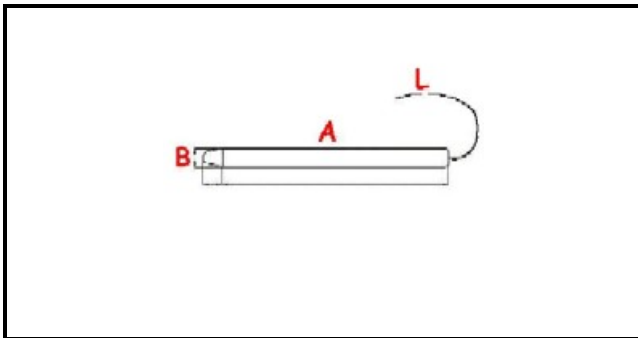

1106825

TERM.EVAP.RANCO K61-S1511 250V 6A CAPIL

Data: 06-01-2025

ORIGINAL
OSP
SPARE PARTS**Dati tecnici**

MONOFASE	MONOFASE/MONOPHASE
NUMERO POLI	POLI/POLES=4
TEMPERATURA MINIMA °	Tmin=-22°C
TEMPERATURA MASSIMA °	Tmax=-11,5°C
CAPILLARE mm	L=1250mm

Codici produttore

CASTEL MAC SRL

CASTEL MAC SRL