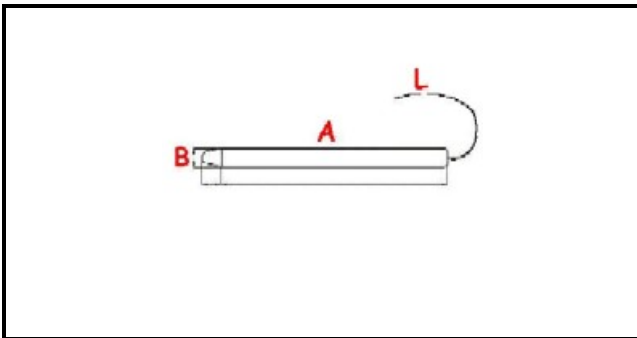

1106844

**TERMOSTATO**

Data: 23-02-2025

ORIGINAL  
**OSP**  
SPARE PARTS**Dati tecnici**

|                       |                    |
|-----------------------|--------------------|
| MONOFASE              | MONOFASE/MONOPHASE |
| NUMERO POLI           | POLI/POLES=2       |
| TEMPERATURA MINIMA °  | Tmin= -2°          |
| TEMPERATURA MASSIMA ° | Tmax=8°            |
| CAPILLARE mm          | L=2000mm           |

**Codici produttore**

ELECTROLUX PROFESSIONAL S.P.A.